

- General Notes
1. Do not scale from this drawing.
  2. All dimensions, co-ordinates, and levels are shown in meters unless otherwise stated.
  3. Tree positions are based on indicative plotting only. As such, tree positions must be treated as indicative only and reviewed on site as required.
  4. © Crown copyright and database rights 2024 Ordnance Survey 100032872
  5. The original of this drawing was produced in colour. A monochrome copy should not be relied upon.

Key Plan

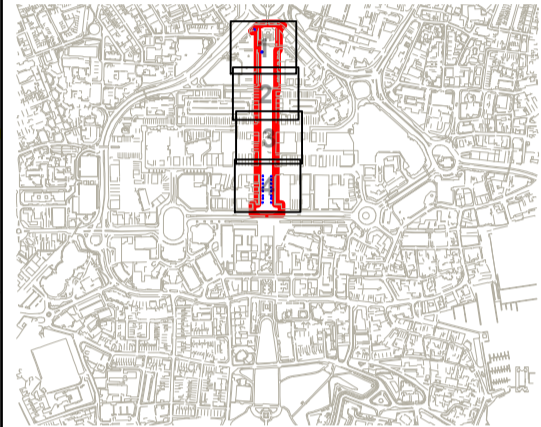

Key

- Survey boundary.
- Site boundary.
- Trees proposed for translocation
- Trees for retention
- Root protection areas (RPA) (as defined by BS 5837:2012)



Revision	By/Check	Date	Suffl

YGS Environmental Consultants Ltd, Lamb Grove, Plymouth, PL2 2ER  
Tel: 01752 337700 E: info@ygs-ec.co.uk W: www.ygs-ec.co.uk  
Contractors must check all dimensions on site, only signed dimensions are to be worked from. Any discrepancies identified must be reported to the landscape architect before proceeding.  
© This drawing is copyright

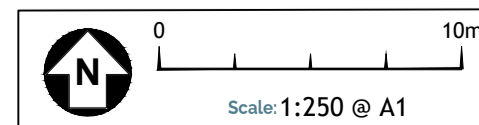

Drawn	Reviewed	Approved	Date
HY	AK	AK	12/01/24
Drawing No	67CA09-YGS-ZZ-XX-DR-J-105		



**Project Title**  
Armada Way

**Client**  
Morgan Sindall  
Construction and  
Infrastructure Ltd

**Drawing Title**  
Tree Protection Plan Draft  
(Sheet 002)

- General Notes**
1. Do not scale from this drawing
  2. All dimension, co-ordinates, and levels are shown in meters unless otherwise stated
  3. Tree positions are based on indicative plotting only. As such, tree positions must be treated as indicative only and reviewed on Site as required.
  4. © Crown copyright and database rights 2024 Ordnance Survey 090002073
  5. The original of this drawing was produced in colour. A monochrome copy should not be relied upon.

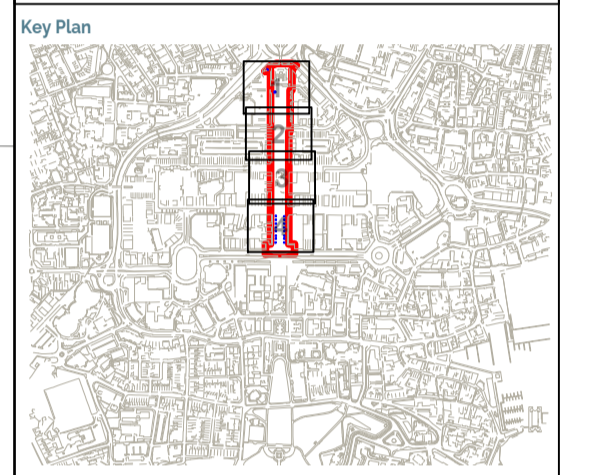

- Key**
- Survey boundary.
  - Site boundary.
  - Trees proposed for translocation
  - Trees for retention
  - Root protection areas (RPA) (as defined by BS 5837:2012)

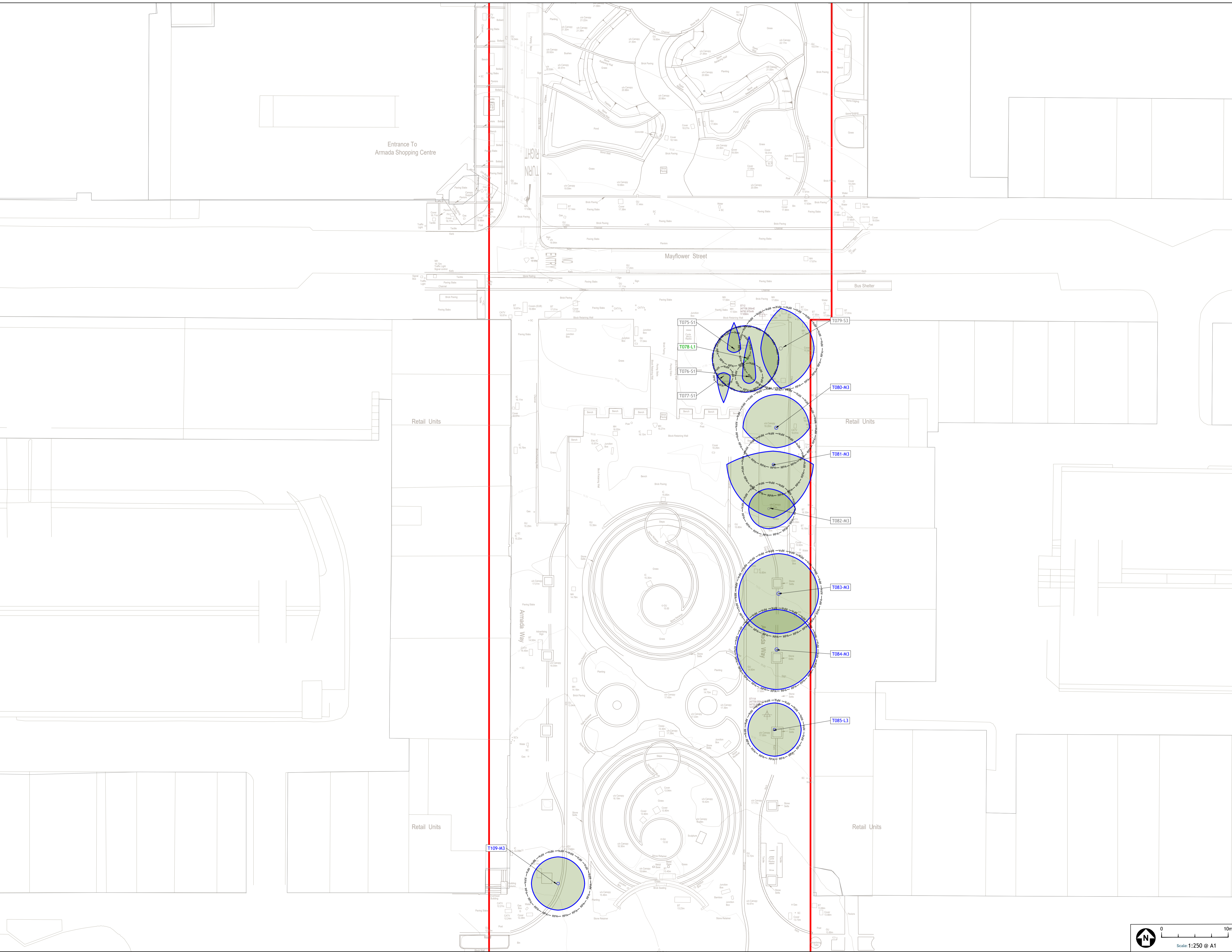

Revision	By/Check	Date	Suffl

YGS Environmental Consultants Ltd, Lamb Grove, Plymouth, PL2 2ER  
Tel: 01752 337700 E: info@ygs-ec.co.uk W: www.ygs-ec.co.uk  
Contractors must check all dimensions on site, only figured dimensions are to be worked from. Any discrepancies identified must be reported to the landscape architect before proceeding.  
© This drawing is copyright

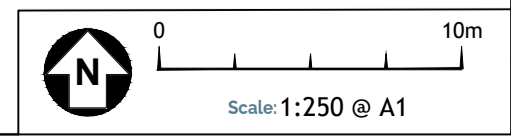

Drawn	Reviewed	Approved	Date
HY	AK	AK	12/01/24

Drawing No: 67CA09-YGS-ZZ-XX-DR-J-106



Project Title  
**Armada Way**

Client  
**Morgan Sindall Construction and Infrastructure Ltd**

Drawing Title  
**Tree Protection Plan Draft (Sheet 003)**

- General Notes
1. Do not scale from this drawing.
  2. All dimensions, co-ordinates, and levels are shown in meters unless otherwise stated.
  3. Tree positions are based on indicative plotting only. As such, tree positions must be treated as indicative only and reviewed on site as required.
  4. © Crown copyright and database rights 2024 Ordnance Survey 100032873
  5. The original of this drawing was produced in colour. A monochrome copy should not be relied upon.

Key Plan

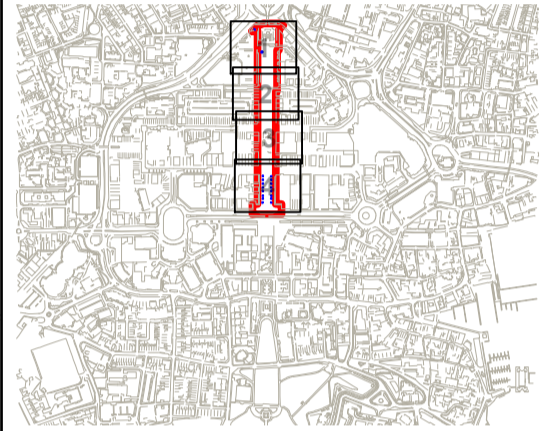

Key

- Survey boundary.
- Site boundary.
- Trees proposed for translocation
- Trees for retention
- Root protection areas (RPA) (as defined by bs 5837:2012)

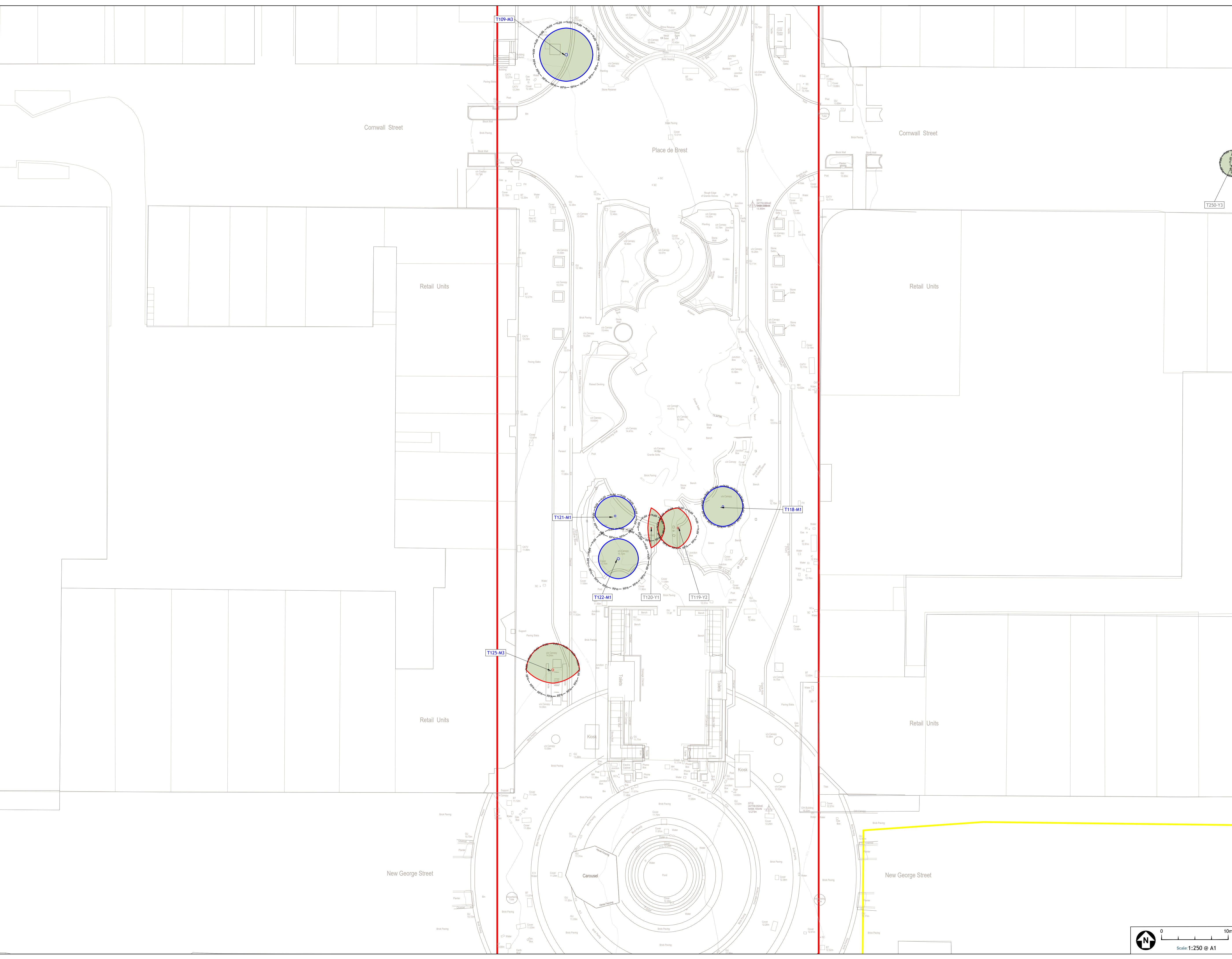

Revision	By/Check	Date	Suffl

YGS Environmental Consultants Ltd, Lamb Grove, Plymouth, PL2 2ER  
Tel: 0232 337700 E: info@ygs-ec.co.uk W: www.ygs-ec.co.uk  
Contractors must check all dimensions on site, only figured dimensions are to be worked from. Any discrepancies identified must be reported to the landscape architect before proceeding.  
© This drawing is copyright

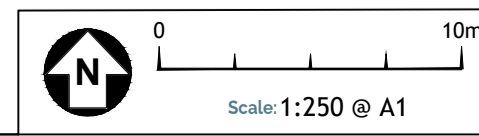

Drawn	Reviewed	Approved	Date
HY	AK	AK	12/01/24

Drawing No: 67CA09-YGS-ZZ-XX-DR-J-107



**Project Title**  
Armada Way

**Client**  
Morgan Sindall  
Construction and  
Infrastructure Ltd

**Drawing Title**  
Tree Protection Plan Draft  
(Sheet 004)

- General Notes**
1. Do not scale from this drawing.
  2. All dimensions, co-ordinates, and levels are shown in meters unless otherwise stated.
  3. Tree positions are based on indicative plotting only. As such, tree positions must be treated as indicative only and reviewed on Site as required.
  4. © Crown copyright and database rights 2024 Ordnance Survey 100032873
  5. The original of this drawing was produced in colour. A monochrome copy should not be relied upon.

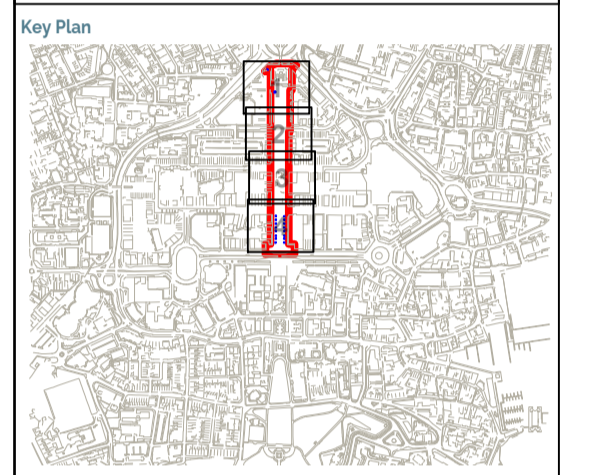

- Key**
- Survey boundary.
  - Site boundary.
  - Trees proposed for translocation
  - Trees for retention
  - Root protection areas (RPA) (as defined by BS 5837:2012)

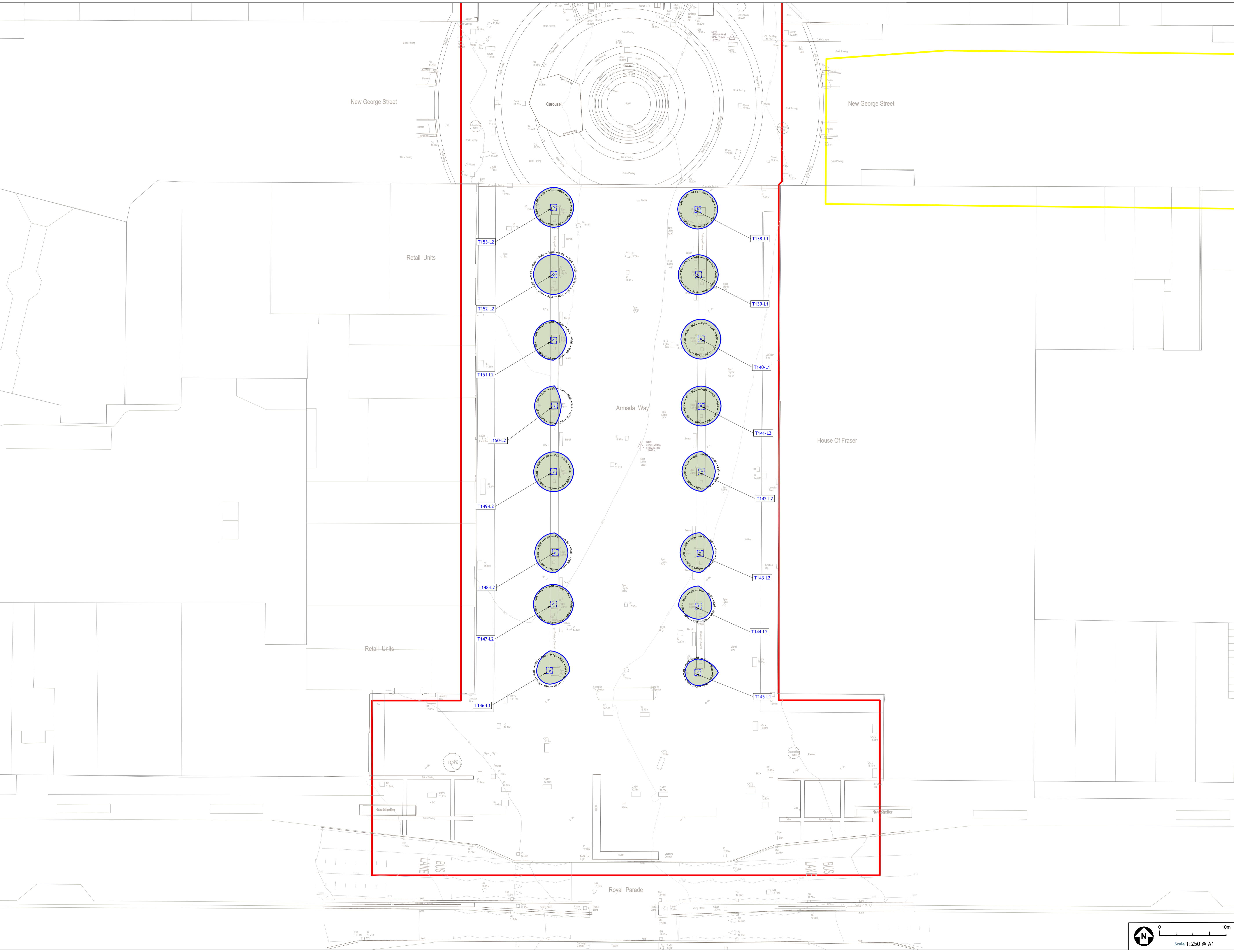

Revision	By/Check	Date	Staff

YGS Environmental Consultants Ltd, Lamb Grove, Plymouth, PL2 2ER  
Tel: 01752 337700 E: info@ygs-ec.co.uk W: www.ygs-ec.co.uk  
Contractors must check all dimensions on site, only signed dimensions are to be worked from. Any discrepancies identified must be reported to the landscape architect before proceeding.  
© This drawing is copyright

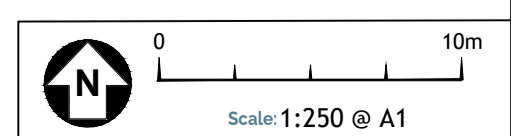

Drawn	Reviewed	Approved	Date
HY	AK	AK	12/01/24
Drawing No			Rev

67CA09-YGS-ZZ-XX-DR-J-108